

NOTICE!!

These documents have been scanned!

Do not place un-scanned documents beneath this notice!

Do not remove this notice from this file!

GPO Jacket No. 560-102
Print Order 61540
Rise Business Services, LLC
Job=AZ15 5/1/2019

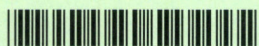

Box Number= AZ15012



Claim Begin-End: AMC440735-AMC440735

1 Initial Receipt



AZ15012-12

AMC440519-AMC441162

United States Department of the Interior
Bureau of Land Management
 DIV OF LANDS, MINRLS & ENERGY
 ONE N CENTRAL AVE
 PHOENIX, AZ 85004 -4427
 Phone: 602-417-9200

Receipt

No: 3733273

Transaction #: 3838650	
Date of Transaction: 12/30/2016	
CUSTOMER:	
	CHARLES WEINHEIMER 196 RAINBOW DR # 9698 LIVINGSTON, TX 77399-1096 US

ENTERED
 JAN - 3 2017
 BY: *[Signature]*

LINE #	QTY	DESCRIPTION	REMARKS	UNIT PRICE	TOTAL
1	1.00	LOCATABLE MINERALS / MINING CLAIMS-NEW, UNADJUD, ONE OR MORE AUTH NOS / NEW MINING CLAIMS LOCATION FEE CASES: AMC440735/\$37.00		- n/a -	37.00
2	1.00	LOCATABLE MINERALS / MINING CLAIMS-NEW, UNADJUD, ONE OR MORE AUTH NOS / NEW MINING CLAIM PROCESSING FEE CASES: AMC440735/\$20.00		- n/a -	20.00
3	1.00	LOCATABLE MINERALS / MINING CLAIMS-NEW, UNADJUD, ONE OR MORE AUTH NOS / NEW MINING CLAIMS MAINTENANCE FEE CASES: AMC440735/\$155.00		- n/a -	155.00
TOTAL:					\$212.00

PAYMENT INFORMATION			
1	AMOUNT:	212.00	POSTMARKED: 12/27/2016
	TYPE:	CHECK	RECEIVED: 12/29/2016
	CHECK NO:	1211	
	NAME:	WEINHEIMER, CHARLES D 196 RAINBOW DR # 9698 LIVINGSTON TX 77399-1096 US	

REMARKS	

This receipt was generated by the automated BLM Collections and Billing System and is a paper representation of a portion of the official electronic record contained therein.

NOTICE!!

These documents have been scanned!

Do not place un-scanned documents beneath this notice!

Do not remove this notice from this file!

GPO Jacket No. 560-102
Print Order 61540
Rise Business Services, LLC
Job=AZ15 5/1/2019



Box Number= AZ15012



Claim Begin-End: AMC440735-AMC440735

2 Correspondence



AZ15012-12

AMC440519-AMC441162

**NO
DOCUMENTS
FOUND**

NO DOCUMENTS FOUND
NO DOCUMENTS FOUND

NOTICE!!

These documents have been scanned!

Do not place un-scanned documents beneath this notice!

Do not remove this notice from this file!

GPO Jacket No. 560-102
Print Order 61540
Rise Business Services, LLC
Job=AZ15 5/1/2019



Box Number= AZ15012



Claim Begin-End: AMC440735-AMC440735

3 Transfers



AZ15012-12

AMC440519-AMC441162

**NO
DOCUMENTS
FOUND**

NO DOCUMENTS FOUND
NO DOCUMENTS FOUND

NOTICE!!

These documents have been scanned!

Do not place un-scanned documents beneath this notice!

Do not remove this notice from this file!

GPO Jacket No. 560-102
Print Order 61540
Rise Business Services, LLC
Job=AZ15 5/1/2019



Box Number= AZ15012



Claim Begin-End: AMC440735-AMC440735

4 Annual Filings



AZ15012-12

AMC440519-AMC441162

UNITED STATES
DEPARTMENT OF THE INTERIOR
BUREAU OF LAND MANAGEMENT
MAINTENANCE FEE WAIVER CERTIFICATION

40

RAM

436467
437933
FORM APPROVED
OMB NO. 1004-0114 440735
Expires: January 31, 2020

SEE INSTRUCTIONS ON PAGE 2

- This small miner waiver is filed for the assessment year beginning on September 1, 2018 and ending on September 1, 2019
- The undersigned and all related parties owned ten or fewer mining claims, mill, or tunnel sites located and maintained on Federal lands in the United States of America on September 1, 2018
- The undersigned have performed the assessment work required by law for each mining claim listed prior to filing this waiver and understand that by filing this form, the undersigned must file an affidavit of assessment work with the Bureau of Land Management (BLM) by the December 30th following the filing of this waiver
- The undersigned understand that if the assessment work obligation has not yet come due under 30 U.S.C. 28 (for those claims in their first assessment year only), a notice of intent to hold reciting this condition must be recorded by the December 30th following the filing of this waiver
- The undersigned understand that mill and tunnel sites may also be listed on this waiver and be waived from payment of the maintenance fee, and that a notice of intent to hold for these sites is required to be filed with the BLM by the December 30th following the filing of this waiver
- The undersigned understand and acknowledge that pursuant to 43 U.S.C. 1212 and 18 U.S.C. 1001, the filing or recording of a false, fictitious, or fraudulent document with the BLM may result in a fine of up to \$250,000, a prison term not to exceed five years, or both.
- The mining claims, mill or tunnel sites for which this waiver from payment of the maintenance fees is requested are:

CLAIM OR SITE NAME	BLM RECORDATION SERIAL NUMBER
1. Gopher Hole ✓	AMC 436467
2. Gopher Wash	AMC 437933
3. Gopher Broke	AMC 440735
4.	
5.	
6.	
7.	
8.	
9.	
10.	

The owner(s) (claimant(s)) of the above mining claims and sites are:

Charles Weinheimer

(Owner's Name - Please Print)

196 Rainbow Dr #9698

(Owner's Mailing Address)

Charles Weinheimer

(Owner's Signature)

Livingston

(City)

TX

(State)

77399

(Zip Code)

JANICE WEINHEIMER

(Owner's Name - Please Print)

196 Rainbow Dr #9698

(Owner's Mailing Address)

JANICE WEINHEIMER

(Owner's Signature)

Livingston

(City)

TX

(State)

77399

(Zip Code)

(Owner's Name - Please Print)

(Owner's Signature)

(Owner's Mailing Address)

(City)

(State)

(Zip Code)

(Owner's Name - Please Print)

(Owner's Signature)

(Owner's Mailing Address)

(City)

(State)

(Zip Code)

(Continued on page 2)

483
ENTERED
SEP 07 2013
BY: [Signature]

NEW
K

(Owner's Name - Please Print)	(Owner's Signature)		
(Owner's Mailing Address)	(City)	(State)	(Zip Code)
(Owner's Name - Please Print)	(Owner's Signature)		
(Owner's Mailing Address)	(City)	(State)	(Zip Code)
(Owner's Name - Please Print)	(Owner's Signature)		
(Owner's Mailing Address)	(City)	(State)	(Zip Code)
(Owner's Name - Please Print)	(Owner's Signature)		
(Owner's Mailing Address)	(City)	(State)	(Zip Code)

18 U.S.C. 1001 and 43 U.S.C. 1212 make it a crime for any person knowingly and willfully to make to any department or agency of the United States any false, fictitious or fraudulent statements or representations as to any matter within its jurisdiction.

INSTRUCTIONS

1. This certification is made under the provisions of 43 U.S.C. § 1744 and 30 U.S.C. §28-28k and the regulations thereunder (43 CFR Part 3830).
2. The claimant(s) must fill in the dates in paragraph 1 for the beginning and ending of the assessment year for which this waiver is sought.
3. The claimant(s) must fill in the date in paragraph 2 for the beginning of the assessment year for which this waiver is sought.
4. All claim and site names and BLM serial numbers must be listed for the mining claims, mill sites, and tunnel sites for which the waiver is sought.
5. All owners of the mining claims, mill sites, and tunnel sites and their addresses must be given.
6. This waiver form must be signed by all the claimants or their designated agent, in original form. If an agent is designated, a notarized designation of agent, signed by all of the claimants with proper address given, must be submitted with this waiver.
7. This form must be filed no later than September 1st for the upcoming assessment year in the BLM State Office where the mining claims or sites are recorded, or the waiver cannot be granted by the BLM (Example: To obtain a waiver for the assessment year 2012, which begins on September 1, 2011, you must qualify for and file for a waiver no later than September 1, 2011, in the proper BLM State Office.)
8. For all mining claims which require assessment work, you must record an affidavit of labor on or before the December 30th immediately following the filing of this waiver. For all other mining claims or sites waived, you must record a notice of intent to hold on or before the December 30th immediately following the filing of this waiver.
9. Mill and tunnel sites may also be listed on this waiver and be waived from payment of the maintenance fee. A notice of intent to hold for these sites is required to be filed by the December 30th following the filing of this waiver.

FOR OFFICIAL USE ONLY

2018 APR 26 PM 1:36

196 RAINBOW DR #9698
LIVINGSTON, TX
77399

RECEIVED
RIM

2018 APR 26 P 1:35

PHOENIX, ARIZONA

B.L.M

1 North Central

Phoenix, AZ

85004-441498

85004

PHOENIX AZ 852
25 APR 2018 PM 10:1



When Recorded Return Document to:

Charles Weinheimer
196 Rainbow Dr #9698
LIVINGSTON, TX
77399

☐ Check here if this is a change of address.

Telephone: 304-483-5015

E-mail address: _____

2016-04-17
SHELLEY D BAKER, RECORDER
OFFICIAL RECORDS OF LA PAZ COUNTY, AZ
04-11-2018 11:47 AM Recording Fee \$15.00

436467
440735

437933

AFFIDAVIT OF PERFORMANCE OF ANNUAL WORK

1. State of Arizona, County of LA PAZ ss:

2. I (Name) Charles Weinheimer

3. Reside at (Address) 196 Rainbow Dr #9698

City LIVINGSTON County PORK

State TX Zip 77399 being duly sworn, depose and say that I am a citizen of the United States, more than eighteen years of age, and that all of the facts set forth in this affidavit, subject to the provisions and penalties of 18 U.S.C. 1001 pertaining to the filing of false, fictitious, or fraudulent statements with the United States, are true and correct according to the best of my knowledge, information and belief.

4. Owner's name and address (If not shown in Items 1-3 above). _____

5. That I am personally acquainted with the mining claim(s). The work and improvements were made by and at the expense of the owner(s) of said claim(s). Said contiguous group of claims, listed on this document, are situated in the

(optional) Mining District: LA PAZ County, Arizona.

Line No.	AMC NUMBER	CLAIM/SITE NAME	COUNTY RECORDER DATA (If available)	TWP	RNG	SEC
1	434467	Copper Hole	2016-0009	3N	20W	14
2	440735	Copper Brake	2016-04395	3N	20W	14
3						
4						
5						
6						

4141130

Form: MCF108
Revised Jan. 2006
Page 1 of 2

APR 23 2018

RAN

AFFIDAVIT OF PERFORMANCE OF ANNUAL WORK – page 2

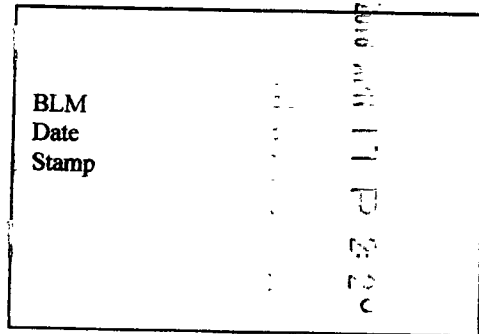

7						
8						
9						
10						

6. That between the dates starting at 12 o'clock noon on September 1, 20 17 and ending at 12 o'clock noon on September 1, 20 18 at least \$ 300 dollars worth of work and improvements were done and performed upon said claim(s) or upon one or more of a contiguous group of claims for the benefit of all, wholly or partly outside of a contiguous group of claims for the benefit of all, not including the location work.

7. That the following persons were employed to perform the work and improvements described herein: Charles Weinheimer, Raymond DeCortez

8. That the work and improvements performed were: Fill in holes, replace missing

9. Dated: 4-11-18 Signature: Charles Weinheimer

SUBSCRIBED AND SWORN TO before me, a Notary Public, this 11th day of April 2018

By: Amy LoPresti

Notary Public Amy LoPresti

My Commission Expires 12/27/21

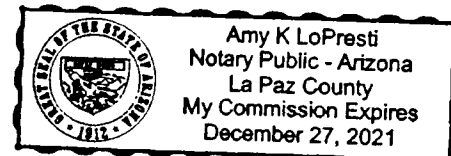

Bureau of Land Management
Arizona State Office
www.az.blm.gov

No. of Claims: _____ x \$10 = _____
Check No.: _____ Init. _____
Receipt No.: _____
For BLM Use Only

When Recorded Return Document to:

JIZHICE WEINHEIMER
196 RAINBOW DR # 9695
LIVINGSTON, TX
77399

☐ Check here if this is a change of address.

Telephone: 304-483-5015

E-mail address: _____

AFFIDAVIT OF PERFORMANCE OF ANNUAL WORK

1. State of Arizona, County of LA PUEBLO ss:

2. I (Name) JIZHICE WEINHEIMER

3. Reside at (Address) 196 RAINBOW DR # 9695

City LIVINGSTON County ROCK

State TX Zip 77399 being duly sworn, depose and say that I am a citizen of the United States, more than eighteen years of age, and that all of the facts set forth in this affidavit, subject to the provisions and penalties of 18 U.S.C. 1001 pertaining to the filing of false, fictitious, or fraudulent statements with the United States, are true and correct according to the best of my knowledge, information and belief.

4. Owner's name and address (If not shown in Items 1-3 above). _____

5. That I am personally acquainted with the mining claim(s). The work and improvements were made by and at the expense of the owner(s) of said claim(s). Said contiguous group of claims, listed on this document, are situated in the

(optional) Mining District: LA PUEBLO County, Arizona.

Line No.	AMC NUMBER	CLAIM/SITE NAME	COUNTY RECORDER DATA (If available)	TWP	RNG	SEC
1	437933	Cepher WASH	2014-01551	3N	20W	14
2						
3						
4						
5						
6						

AFFIDAVIT OF PERFORMANCE OF ANNUAL WORK – page 2

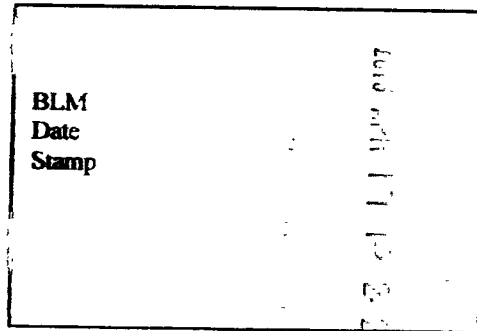

7						
8						
9						
10						

6. That between the dates starting at 12 o'clock noon on September 1, 2017 and ending at 12 o'clock noon on September 1, 2018 at least \$ 150 dollars worth of work and improvements were done and performed upon said claim(s) or upon one or more of a contiguous group of claims for the benefit of all, wholly or partly outside of a contiguous group of claims for the benefit of all, not including the location work.

7. That the following persons were employed to perform the work and improvements described herein: Charles Weinheimer, Raymond DeCoster

8. That the work and improvements performed were: Fill Holes,

9. Dated: 7-11-18 Signature: Janice Weinheimer

SUBSCRIBED AND SWORN TO before me, a Notary Public, this 11th day of April 2018

By: Amy LoPresti

Notary Public: Amy LoPresti

My Commission Expires 12/27/21

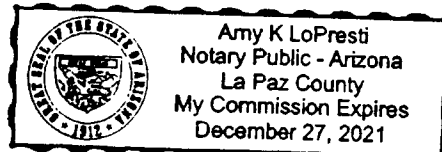

Bureau of Land Management
Arizona State Office
www.blm.gov

No. of Claims: _____ x \$10 = _____
 Check No.: _____ Init. _____
 Receipt No.: _____
 For BLM Use Only

196 Rainbow DR #9698
Livingston, TX 77399

PHOENIX AZ 852

13 APR 2018 PM 3 L

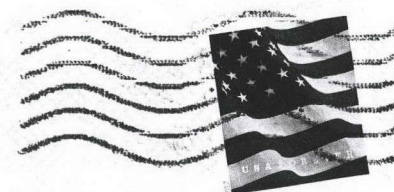

B. L. M

1 North Central Ave
Suite 200
Phoenix, AZ

PHOENIX, ARIZONA

2018 APR 17 P 2:25

RECEIVED

85004-4427

85004-442700

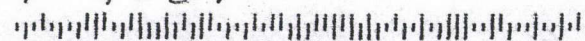

United States Department of the Interior
Bureau of Land Management
DIV OF LANDS, MINRLS & ENERGY
ONE N CENTRAL AVE
PHOENIX, AZ 85004 -4427
Phone: 602-417-9200

Receipt

No: 4141130

Transaction #: 4254977

Date of Transaction: 04/18/2018

CUSTOMER:

CHARLES WEINHEIMER
196 RAINBOW DR # 9698
LIVINGSTON, TX 77399-1096 US

LINE #	QTY	DESCRIPTION	REMARKS	UNIT PRICE	TOTAL
1	1.00	LOCATABLE MINERALS / MINING CLAIMS- NOT NEW-UNADJUD, ONE AUTH NO. ONLY / MINING CLAIM MONEY RECEIVED CASES: AMC440735/\$30.00	POL 2018/3	- n/a -	30.00
TOTAL:					\$30.00

PAYMENT INFORMATION					
1	AMOUNT:	30.00		POSTMARKED:	N/A
	TYPE:	CHECK		RECEIVED:	04/17/2018
	CHECK NO:	1245			
	NAME:	WEINHEIMER, CHARLES 196 RAINBOW DR # 9698 LIVINGSTON TX 77399-1096 US			

REMARKS

This receipt was generated by the automated BLM Collections and Billing System and is a paper representation of a portion of the official electronic record contained therein.

UNITED STATES
DEPARTMENT OF THE INTERIOR
BUREAU OF LAND MANAGEMENT
MAINTENANCE FEE WAIVER CERTIFICATION

19

436467
437933

FORM APPROVED 440735
OMB NO. 1004-0114
Expires: October 31, 2016

SEE INSTRUCTIONS ON PAGE 2

1. This small miner waiver is filed for the assessment year beginning on September 1, 2017 and ending on September 1, 2018.
2. The undersigned and all related parties owned ten or fewer mining claims, mill, or tunnel sites located and maintained on Federal lands in the United States of America on September 1, 2017.
3. The undersigned have performed the assessment work required by law for each mining claim listed prior to filing this waiver and understand that by filing this form, the undersigned must file an affidavit of assessment work with the Bureau of Land Management (BLM) by the December 30th following the filing of this waiver.
4. The undersigned understand that if the assessment work obligation has not yet come due under 30 U.S.C. 28 (for those claims in their first assessment year only), a notice of intent to hold reciting this condition must be recorded by the December 30th following the filing of this waiver.
5. The undersigned understand that mill and tunnel sites may also be listed on this waiver and be waived from payment of the maintenance fee, and that a notice of intent to hold for these sites is required to be filed with the BLM by the December 30th following the filing of this waiver.
6. The undersigned understand and acknowledge that pursuant to 43 U.S.C. 1212 and 18 U.S.C. 1001, the filing or recording of a false, fictitious, or fraudulent document with the BLM may result in a fine of up to \$250,000, a prison term not to exceed five years, or both.
7. The mining claims, mill or tunnel sites for which this waiver from payment of the maintenance fees is requested are:

CLAIM OR SITE NAME	BLM RECORDATION SERIAL NUMBER
1. Gopher Hole	✓ AMC 436467
2. Gopher Wash	AMC 437933
3. Gopher Brook	AMC 440735
4.	
5.	
6.	
7.	
8.	
9.	
10.	

The owner(s) (claimants) of the above mining claims and sites are:

MW Check
2 of

Charles Weinheimer

(Owner's Name - Please Print)

196 Rainbow Dr # 9698

(Owner's Mailing Address)

Charles Weinheimer

(Owner's Signature)

LIVINGSTON

(City)

TX

(State)

77399

(Zip Code)

1 of Janice Weinheimer

(Owner's Name - Please Print)

196 Rainbow Dr # 9698

(Owner's Mailing Address)

Janice Weinheimer

(Owner's Signature)

LIVINGSTON

(City)

TX

(State)

77399

(Zip Code)

(Owner's Name - Please Print)

(Owner's Signature)

(Owner's Mailing Address)

(City)

(State)

(Zip Code)

(Owner's Name - Please Print)

(Owner's Signature)

(Owner's Mailing Address)

(City)

(State)

(Zip Code)

(Continued on page 2)

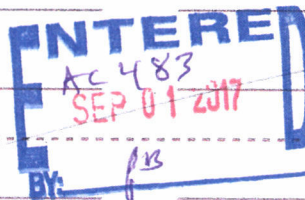

UNITED STATES DEPARTMENT OF THE INTERIOR
BUREAU OF LAND MANAGEMENT

MC NATIONWIDE CLAIMANT LISTING
September 01, 2017

Cust	AZ	National
	CLAIMANT	Total
WEINHEIMER CHARLES 196 RAINBOW DR # 9698 LIVINGSTON, TX 77399-1096	2	2
WEINHEIMER JANICE 196 RAINBOW DR # 9698 LIVINGSTON, TX 77399-1096	1	1

440735

NOTICE OF INTENTION TO HOLD MINING CLAIMS/SITES

When Recorded Return Document to:

Charles Weinheimer
196 Rainbow Dr #9698
LIVINGSTON, TX 77399

BLM
 Date
 Stamp

2017 APR 17 P 3:44

☐ Check here if this is a change of address.
Telephone: 304-483-5015

E-mail Address _____

I (We) intend to hold the claims(s) and/or site(s) listed below for the calendar year 2017, and I (We) have filed or will file a Notice of Intent to Hold in the county where the claim (s) is located.

Reason for filing a Notice of Intent to Hold instead of an assessment work filing (check one):

- ☐ Maintenance fee was paid to maintain claim(s) during this assessment year.
☐ Mill or tunnel sites.
☒ Claim(s) was located during the current assessment year.
☐ BLM has deferred assessment work (attach copy of decision granting deferment, or pending petition for deferment including date petition was filed.)

Line No.	AMC NUMBER	CLAIM/SITE NAME	COUNTY RECORDER DATA (If available)	TWP	RNG	SEC
1	440735	Gopher Broke	2016-04174	3N	20W	14
2						
3						
4						
5						
6						
7						
8						
9						
10						



Form: MCF110

Revised Jan. 2006

Page 1 of 2

NOTICE OF INTENTION TO HOLD MINING CLAIMS/SITES
page 2

BLM Date Stamp	2017 JUN 17 10 31 AM
----------------------	----------------------

1. State of Arizona, County of LA PAZ

2. I (Name) Charles Weinheimer

3. Reside at (Address) 196 Rainbow Dr # 9698

City HUINGTON County POHAK State TX Zip 77399 being duly sworn, depose and say that I am a citizen of the United States, more than eighteen years of age, that all of the facts set forth in this notice, subject to the provisions and penalties of 18 U.S.C. 1001 pertaining to the filing of false, fictitious, or fraudulent statements with the United States, are true and correct according to the best of my knowledge, information and belief.

4. Owner's name and address (If not shown in Items 1-3 above). _____

5. Dated: 4/12/17 Signature: Charles Weinheimer

Bureau of Land Management
 Arizona State Office
www.az.blm.gov

No. of Claims: _____ x \$10 = _____
Check No: _____ Init. _____
Receipt No.: _____
For BLM Use Only

Form: MCF110
 Revised Jan. 2006
 Page 2 of 2

C. Weinberger
196 Rankin Dr.
#9698
Livingston, TX 77399

PHOENIX AZ 850

13 APR 2017 PM 6:17



PHOENIX, ARIZONA

2017 APR 17 P 3:43

RECEIVED
CLM AZ 85000

B. L. M

1 N Central Ave

Box 555

Phoenix, AZ



United States Department of the Interior
Bureau of Land Management
DIV OF LANDS, MINRLS & ENERGY
ONE N CENTRAL AVE
PHOENIX, AZ 85004 -4427
Phone: 602-417-9200

Receipt

No: 3811939

Transaction #: 3919766	
Date of Transaction: 04/18/2017	
CUSTOMER:	
	CHARLES WEINHEIMER 196 RAINBOW DR # 9698 LIVINGSTON, TX 77399-1096 US

LINE #	QTY	DESCRIPTION	REMARKS	UNIT PRICE	TOTAL
1	1.00	LOCATABLE MINERALS / MINING CLAIMS- NOT NEW-UNADJUD, ONE AUTH NO. ONLY / MINING CLAIM MONEY RECEIVED CASES: AMC436467/\$30.00	POL 2017/2 WAV NOI 2017/1	- n/a -	30.00
TOTAL:					\$30.00

PAYMENT INFORMATION			
1	AMOUNT:	20.00	POSTMARKED: 04/13/2017
	TYPE:	CHECK	RECEIVED: 04/17/2017
	CHECK NO:	1222	
	NAME:	WEINHEIMER, CHARLES D 196 RAINBOW DR # 9698 LIVINGSTON TX 77399-1096 US	
2	AMOUNT:	10.00	POSTMARKED: 04/13/2017
	TYPE:	CHECK	RECEIVED: 04/17/2017
	CHECK NO:	1223	
	NAME:	WEINHEIMER, CHARLES D 196 RAINBOW DR # 9698 LIVINGSTON TX 77399-1096 US	

REMARKS

This receipt was generated by the automated BLM Collections and Billing System and is a paper representation of a portion of the official electronic record contained therein.

NOTICE!!

These documents have been scanned!

Do not place un-scanned documents beneath this notice!

Do not remove this notice from this file!

GPO Jacket No. 560-102
Print Order 61540
Rise Business Services, LLC
Job=AZ15 5/1/2019



Box Number= AZ15012



Claim Begin-End: AMC440735-AMC440735

5 Miscellaneous



AZ15012-12

AMC440519-AMC441162

United States Department of the Interior
Bureau of Land Management
 DIV OF LANDS, MINRLS & ENERGY
 ONE N CENTRAL AVE
 PHOENIX, AZ 85004 -4427
 Phone: 602-417-9200

Receipt

No: 4004369

Transaction #: 4114863	
Date of Transaction: 10/27/2017	
AC 635 (LRO to Match Map)	
CUSTOMER:	
CHARLES WEINHEIMER 196 RAINBOW DR # 9698 LIVINGSTON, TX 77399-1096 US	ENTERED Corrected Amendment NOV 15 2017 BY: <u>FB</u>

AMENDMENT PLACED ON TOP OF THE ORIGINAL LOCATION NOTICE - ^{pg}

LINE #	QTY	DESCRIPTION	REMARKS	UNIT PRICE	TOTAL
1	1.00	LOCATABLE MINERALS / MINING CLAIMS- NOT NEW-UNADJUD, ONE AUTH NO. ONLY / MINING CLAIM MONEY RECEIVED CASES: AMC440735/\$10.00	AMEND/1	- n/a -	10.00
TOTAL:					\$10.00

PAYMENT INFORMATION			
1	AMOUNT:	10.00	POSTMARKED: N/A
	TYPE:	CHECK	RECEIVED: 10/26/2017
	CHECK NO:	2734	
	NAME:	WEINHEIMER, CHARLES 196 RAINBOW DR # 9698 LIVINGSTON TX 77399-1096 US	

REMARKS

This receipt was generated by the automated BLM Collections and Billing System and is a paper representation of a portion of the official electronic record contained therein.

C. Weikheimer
196 RAINBOW DR #698
LIVINGSTON, TX
77399

PHOENIX AZ 852

09 NOV 2017 PM 3 L



B.L.M.
one North Central Ave
Phoenix, AZ
85004

RECEIVED
DLM AZ STATE OFFICE
2017 NOV 13 P 4:00
PHOENIX, ARIZONA

ADJUDICATIONS

85004-200120



C. W. K. H. M.
196 RAINBOW DR #9698
LIVINGSTON, TX
77399

PHOENIX AZ 852

09 NOV 2017 PM 3 L



B. L. M.
one North Central Ave
Phoenix, AZ
85004

RECEIVED
BLM AZ STATE OFFICE
2017 NOV 13 P 4:00
PHOENIX, ARIZONA

ADJUDICATIONS

85004-200120

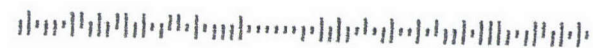

AMC 440735

AMENDED LOCATOR NOTICE

THIS IS AN AMENDMENT TO THE Gopher Broke Placer
Claim Located 15 NOV 2016 AND OF RECORD

2016-04395 IN OFFICE OF COUNTY RECORDER LA PAZ COUNTY,

LOCATION NOTICE FOR PLACER MINING CLAIM

NOTICE IS HEREBY GIVEN that the Gopher Broke

_____ placer mining claim has been located by

Charles Weinheimer whose current mailing

address is 196 Rainbow Dr # 9698

Livingston TX 77399

RECEIVED CLERK OF STATE OFFICE OCT 26 P 3 02 PHOENIX, ARIZONA	BLM Date Stamp
--	----------------------

The general course of this claim is WEST to EAST and it is situated in

LA PAZ County, Arizona.

This claim is 1290 feet in length and 660 feet in width. This claim runs from the

location monument on which this location notice is posted approximately 1290 feet in a EAST

direction to the EAST end line and 660 feet in a SOUTH direction to the SOUTH end line.

This claim is marked by four monuments, one at each corner of the claim.

The location monument on which this notice is posted is situated within Section 14, Township

3 N, Range 20 W, Gila Salt River Base and Meridian, Arizona. This claim encompasses

portions of the following legal subdivision(s) if located by legal subdivision or the following quarter section (s),

section (s), Township (s) and Range (s) E 1/2 of SW 1/4 of SW 1/4 of NE 1/4 AND SE 1/4 of SW 1/4 of NE 1/4

W 1/2 of SW 1/4 of SE 1/4 of NE 1/4, Gila Salt River Base and Meridian, Arizona.

The locality of this claim with reference to some natural object or permanent monument and additional

information (if any) concerning its locality are as follows: THIS EXCLUDES WEST 30' OF E 1/2 of

SW 1/4 of SW 1/4 of NE 1/4 . NORTH WEST CORNER IS 660' SOUTH OF

NORTH SECTION LINE AND 330' EAST OF EAST/WEST CENTER LINE

DATED AND POSTED on the ground this 15 day of NOV, 2016.

LOCATOR (s) Charles Weinheimer

AC635 LLD/MAP
ENTERED OCT 31 2017
PB

Form MCF102
Revised July 2005

This form is available from the Arizona Department of Mines & Mineral Resources and may be reproduced.

4004369

AMC 440735

LLD
DOES NOT
MATCH
MAP. 10
11-7-17 I called CW
He will submit
a corrected
Amendment
11-13-17 corrected
Amendment Rec'd.
PB

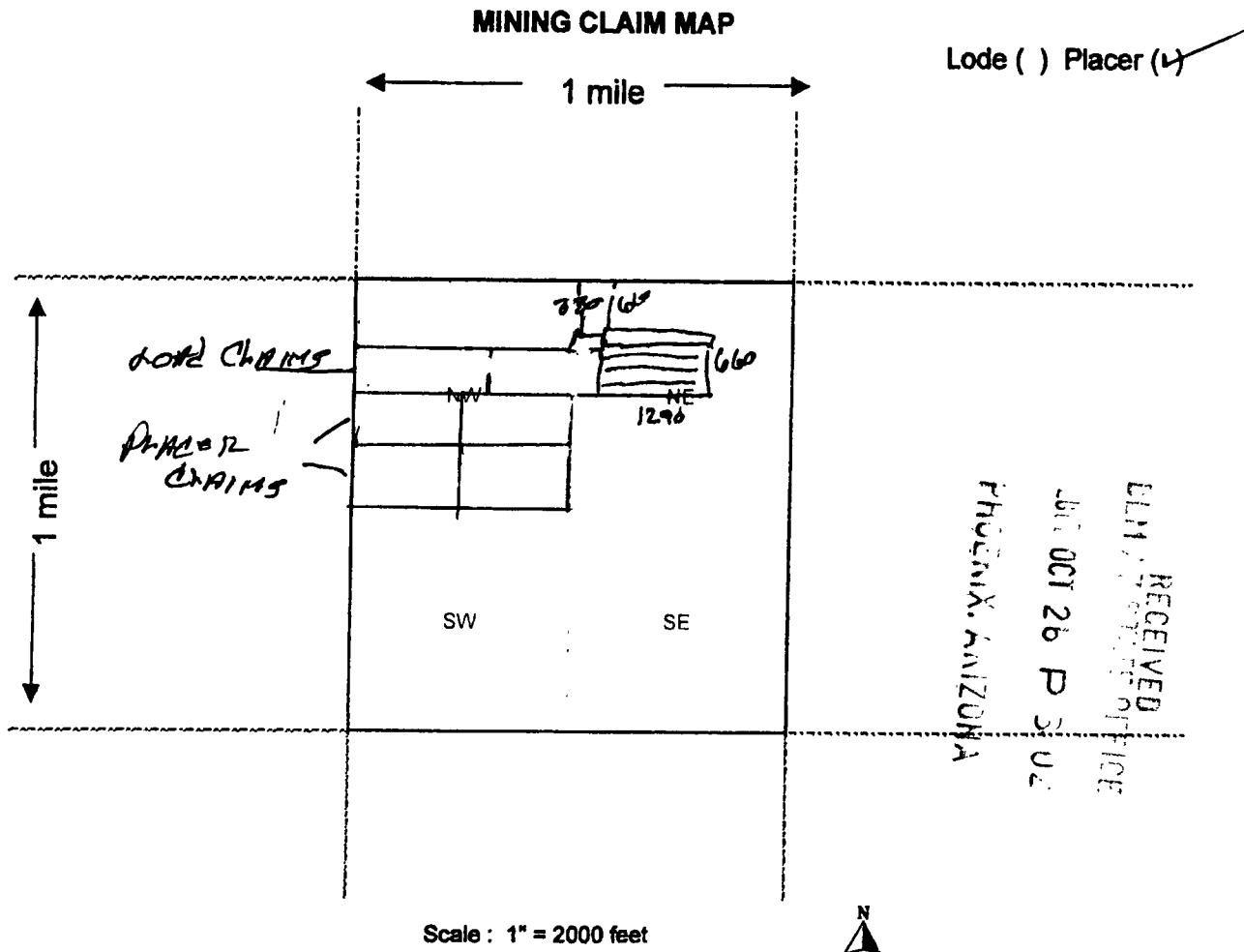

1. The above map depicts the Gopher Broke mining claim, which is located in Section (s) 14, Township 3 N, Range 20 W, Gila and Salt River Base and Meridian, LA PAZ County, Arizona.
2. The type of corner and location monuments used are as follows: 2 x 2 wood
3. The bearings and distances in degrees and feet between claim corners are as depicted on the map.

Form MCF100a
Revised July 2005

This form is available from the Arizona Department of Mines & Mineral Resources and may be reproduced.

United States Department of the Interior
Bureau of Land Management
DIV OF LANDS, MINRLS & ENERGY
ONE N CENTRAL AVE
PHOENIX, AZ 85004 -4427
Phone: 602-417-9200

Receipt

No: 4004369

Transaction #: 4114863	
Date of Transaction: 10/27/2017	
CUSTOMER:	
CHARLES WEINHEIMER 196 RAINBOW DR # 9698 LIVINGSTON, TX 77399-1096 US	<i>Original Amendment placed on top of the Location Notice.</i> ENTERED <i>Removed</i> OCT 31 2017 BY: <i>ps</i>

LLD on AMENDMENT IN ERROR - Must CORRECT ps

LINE #	QTY	DESCRIPTION	REMARKS	UNIT PRICE	TOTAL
1	1.00	LOCATABLE MINERALS / MINING CLAIMS- NOT NEW-UNADJUD, ONE AUTH NO. ONLY / MINING CLAIM MONEY RECEIVED CASES: AMC440735/\$10.00	AMEND/1	- n/a -	10.00
TOTAL:					\$10.00

PAYMENT INFORMATION				
1	AMOUNT:	10.00	POSTMARKED:	N/A
	TYPE:	CHECK	RECEIVED:	10/26/2017
	CHECK NO:	2734		
	NAME:	WEINHEIMER, CHARLES 196 RAINBOW DR # 9698 LIVINGSTON TX 77399-1096 US		

REMARKS

This receipt was generated by the automated BLM Collections and Billing System and is a paper representation of a portion of the official electronic record contained therein.

1916 RAINBOW DR. #9698
LIVINGSTON, TX 77399

PHOENIX AZ 852
25 OCT 2017 PM 3 L



PHOENIX, ARIZONA

2017 OCT 26 P 3:02

RECEIVED
ELM AT STATE OFFICE

B.L.M

1 N. CENTRAL AVE

PHOENIX, AZ

85004

ADJUDICATION:

85004-442700

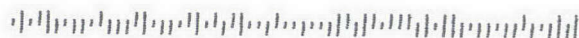

196 RAINBOW DR. #9698
LIVINGSTON, TX 77399

PHOENIX AZ 852

25 OCT 2017 PM 3 L



PHOENIX, ARIZONA

2017 OCT 26 P 3:02

RECEIVED
ELM AT STATE OFFICE

B.L.M

1 N. CENTRAL AVE

PHOENIX, AZ

85004

ADJUDICATION:

85004-442700



**DEPARTMENT OF THE INTERIOR
BUREAU OF LAND MANAGEMENT
MINING CLAIMS**

Run Date/Time: 10/31/2017 09:04 AM

(LIVE) Serial Register Page

Page 1 of 1

01 10-21-1976;090STAT0090;43USC1744

Case Type 384201: PLACER CLAIM

Claim Name: GOPHER BROKE

Commodity :

Case Disposition: ACTIVE

Required Maintenance Fee: \$155.00

Total Acres

19.550

Serial Number

AMC440735

Lead File Number

AMC440735

Name & Address

Int Rel

WEINHEIMER CHARLES

196 RAINBOW DR # 9698

LIVINGSTON, TX 77399-1096

CLAIMANT

Mer Twp Rng Sec

Quadrant

District/Field Office

County

14 0030N 0200W 014

NE

YUMA FO

LA PAZ

Act Date

Code

Action

Action Remarks

Receipt Number

11/15/2016

403

LOCATION DATE

12/29/2016

395

RECORDATION NOTICE RECD

1

3733273

04/17/2017

483

SMALL MINER CERT FILED

2018

12/29/2016

484

LOCATION YEAR / MAINTENANCE 2017;\$155

3733273

04/17/2017

481

NOTICE OF INTENT TO HOLD

2017

3811939

10/26/2017

392

MONIES RECEIVED

\$10.00;1

4004369

10/26/2017

635

AMENDED LOCATION FILED

LLD/MAP

NGEDs TO BE corrected

4004369

10/23/2017

669

LAND STATUS CHECKED

12/29/2016

501

ACCT ADV IN LEAD FILE

AMC440735;

12/14/2016

404

COUNTY RECORDATION

2016-04395;

Line Nr Remarks



NOTICE!!

These documents have been scanned!

Do not place un-scanned documents beneath this notice!

Do not remove this notice from this file!

GPO Jacket No. 560-102
Print Order 61540
Rise Business Services, LLC
Job=AZ15 5/1/2019



Box Number= AZ15012



Claim Begin-End: AMC440735-AMC440735

6 Location Notices-Amendments and Supporting Documents



AZ15012-12

AMC440519-AMC441162

**DEPARTMENT OF THE INTERIOR
BUREAU OF LAND MANAGEMENT
MINING CLAIMS**

Run Date/Time: 11/15/2017 07:23 AM

(LIVE) Serial Register Page

Page 1 of 1

01 10-21-1976;090STAT0090;43USC1744

Case Type 384201: PLACER CLAIM

Claim Name: GOPHER BROKE

Commodity :

Case Disposition: ACTIVE

Required Maintenance Fee: \$155.00

Total Acres

19.550

Serial Number

AMC440735

Lead File Number

AMC440735

Name & Address

Int Rel

WEINHEIMER CHARLES 196 RAINBOW DR # 9698 LIVINGSTON, TX 77399-1096 CLAIMANT

Mer Twp	Rng	Sec	Quadrant	District/Field Office	County
14	0030N	0200W	014	NE	YUMA FO

Act Date	Code	Action	Action Remarks	Receipt Number
11/15/2016	403	LOCATION DATE		
12/29/2016	395	RECORDATION NOTICE RECD	1	3733273
04/17/2017	483	SMALL MINER CERT FILED	2018	
12/29/2016	484	LOCATION YEAR / MAINTENANCE	2017;\$155	3733273
04/17/2017	481	NOTICE OF INTENT TO HOLD	2017	3811939
11/13/2017	635	AMENDED LOCATION FILED	LLD/MAP	4004369
10/26/2017	392	MONIES RECEIVED	\$10.00;2	4004369
10/23/2017	669	LAND STATUS CHECKED		
12/29/2016	501	ACCT ADV IN LEAD FILE	AMC440735;	
12/14/2016	404	COUNTY RECORDATION	2016-04395;	

Line Nr Remarks

MINING CLAIM STATUS REPORT

Data Entered: 3 JAN 17

MTP Checked By:

GEO Checked By:

LEAD SERIAL NUMBER: AMC 440 135 thru AMC

NUMBER OF CLAIMS & TYPE:

CHARGES:

_____	LODE
_____ / _____	PLACER
_____	ASSOCIATION PLACER
_____	MILL SITE
_____	TUNNEL SITE

Location Fee @ \$37 =	\$	37
Processing Fee @ \$20 =	\$	20
Maintenance Fee @ \$155 =	\$	155
Add'l Maint Fee for Assoc Placer =	\$	
SUBTOTAL	\$	212

TOTAL ACREAGE: 20 *Per Claim*
(Placer Only)

_____ Other Fees \$

_____ Other Fees \$

NUMBER OF LOCATORS: 1

TOTAL \$

DOCUMENTS RECEIVED VIA : Over-the-Counter [] Mail [X] TIMELY FILED: Yes [X] No []

LEGAL DESCRIPTION:

T	<u>3N</u>	R	<u>20 W</u>	SEC	<u>14</u>
T	_____	R	_____	SEC	_____
T	_____	R	_____	SEC	_____
T	_____	R	_____	SEC	_____
T	_____	R	_____	SEC	_____

BLM [] FOREST SERVICE [] _____ SUBJ TO PL 359: Yes [] No []
WILDERNESS AREA [] _____

SPLIT ESTATE: N/A ☐ SX ☐ PX ☐ OTHER ☐ _____
 SRHA ☐ Was proper Notice filed if located on SHRA Land? Yes ☐ No ☐

RECONVEYED MINERALS ON BLM LAND REQUIRE OPENING ORDER FROM 1944 TO 1993:

Open to Entry On N/A []

COMMENTS/STATUS: VOID [] PARTIALLY VOID [] PVT MINERALS [] WITHDRAWN LANDS []
OTHER [] M + B Reg. Submitted M + B on 11/13/17 per Amendment 1061

[] Claimant acknowledges that portions of the following claim(s) site(s) may be void or voidable.

Printed Name of Claimant _____ Signature of Claimant _____

*****FINAL ADJUDICATION*****

DATE 10/23/17 INITIALS JB

CORRECTED

Amended LOCATION NOTICE

this is an AMENDMENT to the Gopher Broke
Placer CLAIM located 13 NOV 2016 AND OF RECORD
ZON 4385 IN OFFICE OF RECORDER LA PAZ CO
AMC 440735

LOCATION NOTICE FOR PLACER MINING CLAIM

NOTICE IS HEREBY GIVEN that the Gopher Broke

_____ placer mining claim has been located by

Charles Weinheimer whose current mailing

address is 196 PARKWAY DR # 9698

HIVINGSTON, TX 77359

The general course of this claim is WEST TO EAST and it is situated in

LA PAZ County, Arizona.

This claim is 1290 feet in length and 660 feet in width. This claim runs from the
location monument on which this location notice is posted approximately 1290 feet in a EAST
direction to the EAST end line and 660 feet in a SOUTH direction to the SOUTH end line.
This claim is marked by four monuments, one at each corner of the claim.

The location monument on which this notice is posted is situated within Section 1N, Township
3 N, Range 20 W, Gila Salt River Base and Meridian, Arizona. This claim encompasses
portions of the following legal subdivision(s) if located by legal subdivision or the following quarter section (s),
section (s), Township (s) and Range (s) E 1/2 of SW 1/4 of NW 1/4 of NE 1/4 and SE 1/4 of NW 1/4 of
NE 1/4 and W 1/2 of SW 1/4 of NE 1/4, Gila Salt River Base and Meridian, Arizona.

The locality of this claim with reference to some natural object or permanent monument and additional
information (if any) concerning its locality are as follows: THE EXCHANGES WEST 30' OF
W 1/2 of SW 1/4 of NW 1/4 of NE 1/4 - NORTH WEST CORNER OF CHARLES
660' SOUTH OF NORTH SECTION LINE AND 330' EAST OF EAST/WEST SECTION LINE

DATED AND POSTED on the ground this 15 day of NOV, 2016.

LOCATOR (s) Charles Weinheimer

Form MCF102
Revised July 2005

AMC 440735

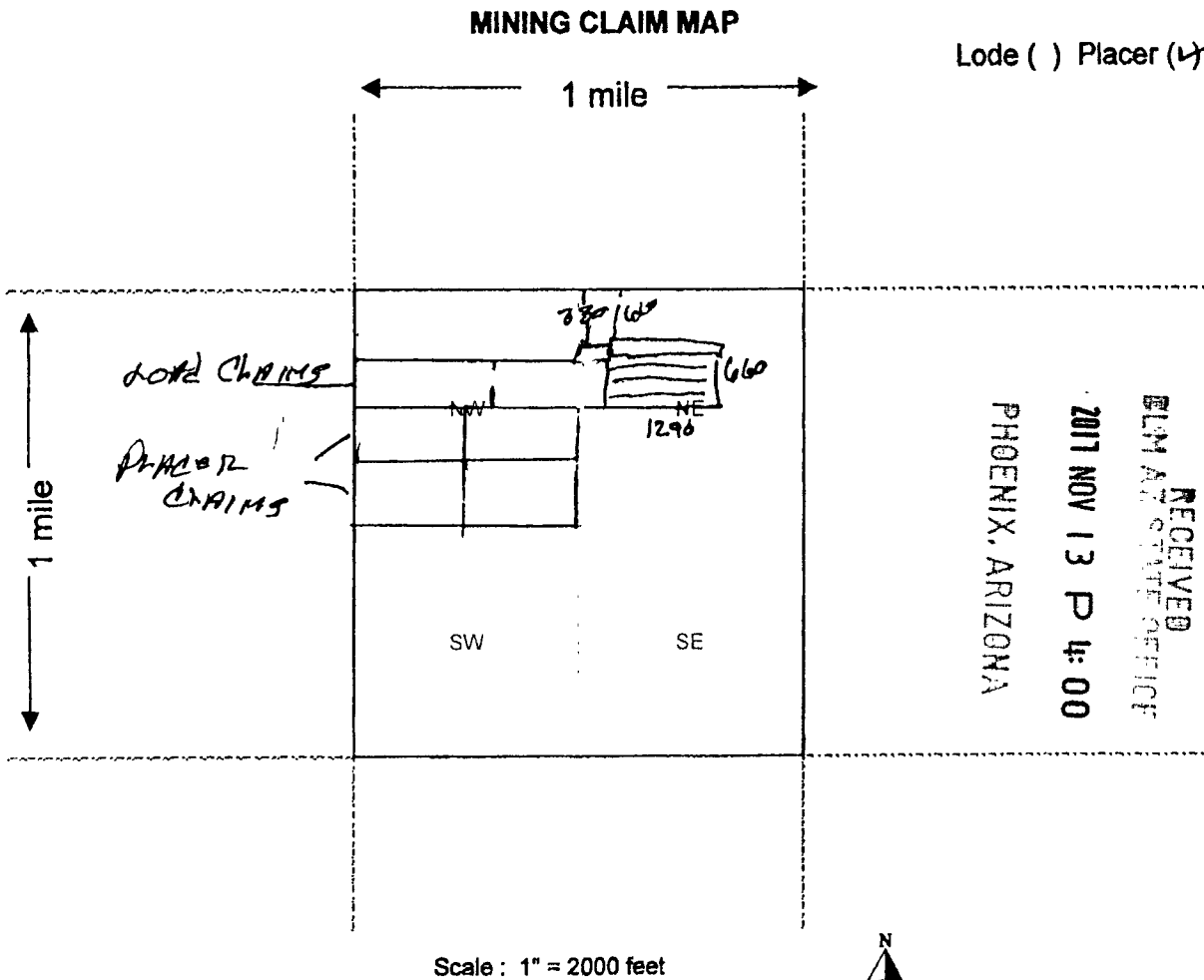

- The above map depicts the Gopher Broke mining claim, which is located in Section (s) 14, Township 3 N, Range 20 W, Gila and Salt River Base and Meridian, LA PAZ County, Arizona.
- The type of corner and location monuments used are as follows: 2 x 2 wood
- The bearings and distances in degrees and feet between claim corners are as depicted on the map.

Form MCF100a
Revised July 2005

This form is available from the Arizona Department of Mines & Mineral Resources and may be reproduced.

AMC 440735

LOCATION NOTICE FOR PLACER MINING CLAIM

NOTICE IS HEREBY GIVEN that the Gopher Broke

_____ placer mining claim has been located by

Charles Weinheimer whose current mailing
address is 196 Rainbow Dr, # 9698Livingston, TX 77399The general course of this claim is West To East and it is situated in
La Paz County, Arizona.This claim is 1320 feet in length and 660 feet in width. This claim runs from the
location monument on which this location notice is posted approximately 1320 feet in a East
direction to the East end line and 660 feet in a South direction to the South end line.

This claim is marked by four monuments, one at each corner of the claim.

The location monument on which this notice is posted is situated within Section 141, Township
3 N, Range 20 W, Gila Salt River Base and Meridian, Arizona. This claim encompasses
portions of the following legal subdivision(s) if located by legal subdivision or the following quarter section (s),
section (s), Township (s) and Range (s) Eastern 960' of S 1/2, NW 1/4, NE 1/4
and Western 360' of S 1/2, SE 1/4, NE 1/4, Gila Salt River Base and Meridian, Arizona.The locality of this claim with reference to some natural object or permanent monument and additional
information (if any) concerning its locality are as follows: _____DATED AND POSTED on the ground this 15 day of Nov, 2016.LOCATOR (s) Charles WeinheimerForm MCF102
Revised July 2005

This form is available from the Arizona Department of Mines & Mineral Resources and may be reproduced.

BLM
Date
StampRECEIVED
2016 DEC 29 P 2:43
PHOENIX, ARIZONA

ANCH 40735

WLD + MAP
DO NOT MARK
Amendment Reg.
PA

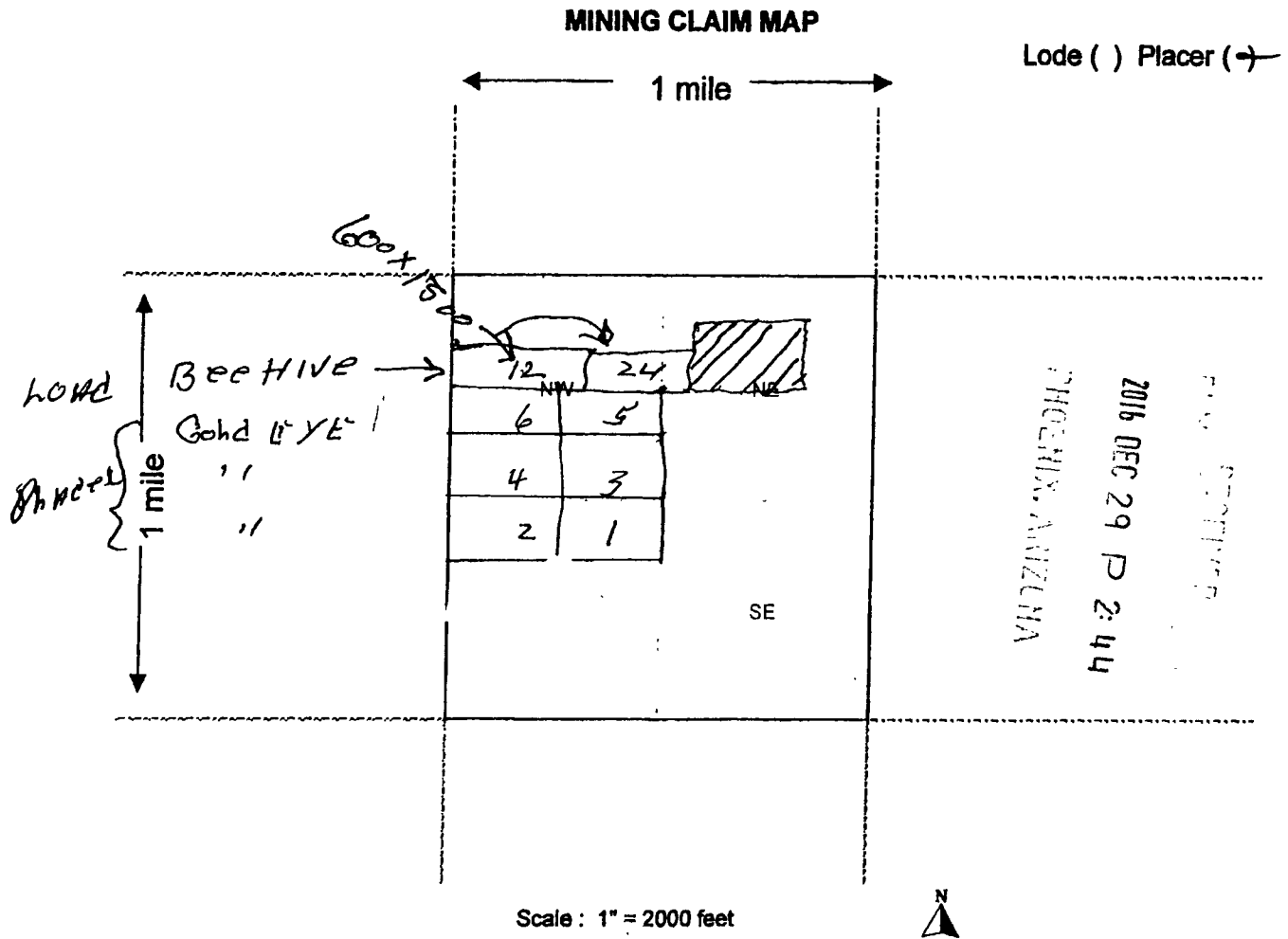

- The above map depicts the Gopher Broke mining claim, which is located in Section (s) 14, Township 3 N, Range 20 W, Gila and Salt River Base and Meridian, LA PRZ County, Arizona.
- The type of corner and location monuments used are as follows: 2x2 wood
- The bearings and distances in degrees and feet between claim corners are as depicted on the map.

Form MCF100a
Revised July 2005

This form is available from the Arizona Department of Mines & Mineral Resources and may be reproduced.

PROTRACTION DIAGRAM NO 17 OFFICIALLY FILED 12/7/1959

STATUS OF PUBLIC DOMAIN LAND AND MINERAL TITLES

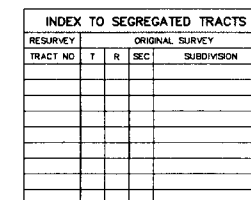

FOR ORDERS AFFECTING DISPOSAL OR USE OF
UNIDENTIFIED LANDS WITHDRAWN FOR CLASSIFICATION,
MINERALS, WATER AND/OR OTHER PUBLIC PURPOSES,
REFER TO INDEX OF MISCELLANEOUS DOCUMENTS

Grazing Dist No 2

AZA 32361 R/W Communication Site
Sec 28. W1/2SW1/4

AZA 35195 R/W Communication Site
Sec 29 E1/2SW1/4

N

33 32'59"N

Long

114 16'08"W

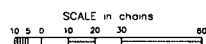

WARNING STATEMENT

WARNING STATEMENT
This plot is the Bureau's Record of Title and should be used only as a graphic display of the township survey data. Records hereon do not reflect title changes which may have been effected by lateral movements of rivers or other bodies of water. Refer to the cadastral surveys for official survey information.

CURRENT TO	NW	GSR Mer
2-10-2016	ACAD	T 3 N
		P 20 W

Input Parameters for Geographic Report with Land

System Id = CR

Admin State = AZ

Geo State =

Casetype Begins With

Case Disp Txt = AUTHORIZED, CANCELLED, EXPIRED, PENDING, REJECTED, RELINQUISHED, WITHDRAWN

Mer Twp Rng =

Section =

Mtrs = 14 0030N 0200W 014, 14 0030N 0200W 999

Commodity =

Commodity Txt =

Pending Org =

Pend Org Decode =

Total Rows Returned: 8

RUN TIME: 09:20 AM

Adm State: AZ

UNITED STATES DEPARTMENT OF INTERIOR
BUREAU OF LAND MANAGEMENT
GEOGRAPHIC REPORT WITH LAND
Sorted by Serial Number

RUN DATE: 01/03/2017
Page 1 of 3

Serial Number: AZA 032508
Total Case Acres: 80.000

<u>Casetype</u>	<u>Case Disp</u>	<u>14</u>	<u>0030N</u>	<u>0200W</u>	<u>Sect</u>	<u>Sur Typ</u>	<u>Sur Num</u>	<u>Suff</u>	<u>Subdivision</u>	<u>Act Pend</u>
292802	PENDING				014	ALIQ			SW;	Y

Serial Number: AZA 033507
Total Case Acres: 4.990

<u>Casetype</u>	<u>Case Disp</u>	<u>14</u>	<u>0030N</u>	<u>0200W</u>	<u>Sect</u>	<u>Sur Typ</u>	<u>Sur Num</u>	<u>Suff</u>	<u>Subdivision</u>	<u>Act Pend</u>
380913	EXPIRED				014	ALIQ			SW;	Y

Serial Number: AZA 034553
Total Case Acres: 10.000

<u>Casetype</u>	<u>Case Disp</u>	<u>14</u>	<u>0030N</u>	<u>0200W</u>	<u>Sect</u>	<u>Sur Typ</u>	<u>Sur Num</u>	<u>Suff</u>	<u>Subdivision</u>	<u>Act Pend</u>
292006	PENDING				014	ALIQ			SE;	Y

Serial Number: AZA 035641
Total Case Acres: 1.000

<u>Casetype</u>	<u>Case Disp</u>	<u>14</u>	<u>0030N</u>	<u>0200W</u>	<u>Sect</u>	<u>Sur Typ</u>	<u>Sur Num</u>	<u>Suff</u>	<u>Subdivision</u>	<u>Act Pend</u>
380913	PENDING				014	ALIQ			SW;	Y

Serial Number: AZA 03571401
Total Case Acres: 1.000

<u>Casetype</u>	<u>Case Disp</u>	<u>14</u>	<u>0030N</u>	<u>0200W</u>	<u>Sect</u>	<u>Sur Typ</u>	<u>Sur Num</u>	<u>Suff</u>	<u>Subdivision</u>	<u>Act Pend</u>
281001	AUTHORIZED				014	FF			E2SW (WITHIN);	Y
						FF			NE (WITHIN);	Y
						FF			S2SE (WITHIN);	Y
						FF			SENW (WITHIN);	Y

RUN TIME: 09:20 AM

Adm State: AZ

UNITED STATES DEPARTMENT OF INTERIOR
BUREAU OF LAND MANAGEMENT
GEOGRAPHIC REPORT WITH LAND
Sorted by Serial Number

RUN DATE: 01/03/2017
Page 2 of 3

Serial Number: AZA 035750

Total Case Acres: 5.000

<u>Casetype</u>	<u>Case Disp</u>	<u>14</u>	<u>0030N</u>	<u>0200W</u>	<u>Sect</u>	<u>Sur Typ</u>	<u>Sur Num</u>	<u>Suff</u>	<u>Subdivision</u>	<u>Act Pend</u>
380913	AUTHORIZED				014	ALIQ			SW,SE;	Y

Serial Number: AZA 035763

Total Case Acres: 1.000

<u>Casetype</u>	<u>Case Disp</u>	<u>14</u>	<u>0030N</u>	<u>0200W</u>	<u>Sect</u>	<u>Sur Typ</u>	<u>Sur Num</u>	<u>Suff</u>	<u>Subdivision</u>	<u>Act Pend</u>
380913	AUTHORIZED				014	ALIQ			NW;	

Serial Number: AZA 036560

Total Case Acres: 0.500

<u>Casetype</u>	<u>Case Disp</u>	<u>14</u>	<u>0030N</u>	<u>0200W</u>	<u>Sect</u>	<u>Sur Typ</u>	<u>Sur Num</u>	<u>Suff</u>	<u>Subdivision</u>	<u>Act Pend</u>
380913	AUTHORIZED				014	ALIQ			SW;	

Serial Number: AZA 036661

Total Case Acres: 0.250

<u>Casetype</u>	<u>Case Disp</u>	<u>14</u>	<u>0030N</u>	<u>0200W</u>	<u>Sect</u>	<u>Sur Typ</u>	<u>Sur Num</u>	<u>Suff</u>	<u>Subdivision</u>	<u>Act Pend</u>
371511	PENDING				014	ALIQ			NW;	

Serial Number: AZA 037005

Total Case Acres: 4.990

<u>Casetype</u>	<u>Case Disp</u>	<u>14</u>	<u>0030N</u>	<u>0200W</u>	<u>Sect</u>	<u>Sur Typ</u>	<u>Sur Num</u>	<u>Suff</u>	<u>Subdivision</u>	<u>Act Pend</u>
380913	AUTHORIZED				014	ALIQ			NW;	

Serial Number: AZA 037053

Total Case Acres: 5.000

<u>Casetype</u>	<u>Case Disp</u>	<u>14</u>	<u>0030N</u>	<u>0200W</u>	<u>Sect</u>	<u>Sur Typ</u>	<u>Sur Num</u>	<u>Suff</u>	<u>Subdivision</u>	<u>Act Pend</u>
-----------------	------------------	-----------	--------------	--------------	-------------	----------------	----------------	-------------	--------------------	-----------------

RUN TIME: 09:20 AM

Adm State: AZ

UNITED STATES DEPARTMENT OF INTERIOR
BUREAU OF LAND MANAGEMENT
GEOGRAPHIC REPORT WITH LAND
Sorted by Serial Number

RUN DATE: 01/03/2017

Page 3 of 3

380910 PENDING

014 ALIQ NE;
ALIQ NW;
ALIQ SE;

Serial Number: AZA 037075

Total Case Acres: 5.000

<u>Casetype</u>	<u>Case Disp</u>	14	0030N	0200W	<u>Sect</u>	<u>Sur Typ</u>	<u>Sur Num</u>	<u>Suff</u>	<u>Subdivision</u>	<u>Act Pend</u>
380913	PENDING				014	ALIQ			NW;	

TOWNSHIP 03 NORTH RANGE 20 WEST OF THE GILA & SALT RIVER MERIDIAN, ARIZONA

SECS	SUBDIVISION																Acres	Kind of Entry or Purpose	Serial Number or Order Number	Action Date	Remarks		
	NE 1/4				NW 1/4				SW 1/4				SE 1/4									Lots	Other Description
	NE	NW	SW	SE	NE	NW	SW	SE	NE	NW	SW	SE	NE	NW	SW	SE							
	For orders affecting disposal or use of unidentified lands withdrawn for classification, minerals, water, and/or other public purposes, and Indian treaties, refer to Index to Miscellaneous Documents																						
6						X	X			X	X						1-4		298 12				
7						X	X			X	X						1-4		269 92				
18						X	X										1-5		207 97	EO ENLGMT COLORADO RIVER INDIAN RESERVATION		11/16/1874	WITHDRAWN FROM SALE, ELIM EO 2273, 11/22/1915, OTHER TPS 3N 21W, 4N 20W, 4N 21W, 4N 22W,
																	LOT 1591 (MS),	62 278	PATENT / ME	38297	4/1/1904	MC 495,	
																	MS 1876,	209 853	PATENT / ME	88732	11/11/1909	MC 1343,	
																	ALL SECS 2, 16, 32, 36,		STATE GRANT	ACT OF CONGRESS	6/20/1910	TITLE TO STATE TO FIX ON APPROVAL OF SURVEY, SUBJECT TO PRIOR RIGHTS,	
6						X	X			X	X						1-4						
7						X	X			X	X						1-4						
18						X	X										1-5			EO ELIM COLORADO RIVER INDIAN RESERVATION, EO 11/16/1874	2273	11/22/1915	OTHER TPS 3N 21W, 4N 20W, 4N 21W,
																	ALL SECS 2, 16, 32, 36,		STATE GRANT	ACT OF CONGRESS	1/25/1927	EXTENDS ACT OF 6/20/1910 TO MINERAL LANDS, SUBJECT TO PRIOR RIGHTS,	
16													X				S2SWSW, SWNWSE, N2SWSE,	90 00					
20																	N2NENE, N2NWNE, SWNWNE, SENENW,	60 00					
21																	NWNNW,	10 00	SO WDL AIR NAVIGATION SITE	158	4/9/1941	WITHDRAWN FROM ALL FORMS OF APPROPRIATION UNDER THE PUBLIC LAND LAWS, LD TP 2N 8W, REV PLO 2694, 6/11/1962,	
2																	ALL,	640 00					
16																	ALL,	640 00					
32	X	X	X	X	X	X	X	X	X	X	X	X	X					480 00					
36	X	X	X	X	X	X	X	X	X	X	X	X	X					480 00	WAIVER / SX	PHX-077470	8/6/1941	8S 10E,	
32														X	X	X	X	160 00					
36														X	X	X	X	160 00	WAIVER / SX	PHX-077474	4/1/1946	15S 21E,	
1																							
2																							
3																							
11																							
12																	M&B, SUBDIV UNDEF,		R/W PIPELINE	PHX-083225	3/1/1949	PERPETUAL, PROOF OF CONSTRUCTION 2/9/1951, LD TP 2N 11W, AMENDED 11/4/1964, AMENDED 9/3/2003,	
1																							

TOWNSHIP 03 NORTH RANGE 20 WEST OF THE GILA & SALT RIVER MERIDIAN, ARIZONA

[illegible]

TOWNSHIP 03 NORTH RANGE 20 WEST OF THE GILA & SALT RIVER MERIDIAN, ARIZONA

SECS	SUBDIVISION																Acres	Kind of Entry or Purpose	Serial Number or Order Number	Action Date	Remarks		
	NE 1/4				NW 1/4				SW 1/4				SE 1/4									Lots	Other Description
	NE	NW	SW	SE	NE	NW	SW	SE	NE	NW	SW	SE	NE	NW	SW	SE							
For orders affecting disposal or use of unidentified lands withdrawn for classification, minerals, water, and/or other public purposes, and Indian treaties, refer to Index to Miscellaneous Documents																							
12			X		X	X	X	X										4N 20W,		R/W PIPELINE	A-1238	4/17/1968	REL AND CASE CLOSED 2/21/1973.
18																	4						
19	X	X	X	X	X	X	X	X					X										
20									X	X	X	X			X								
27											X												
28						X	X	X	X	X	X	X	X	X	X	X							
29	X	X	X	X																			
34	X	X		X	X	X																	
35			X	X		X	X																
36						X	X	X	X				X	X				2N 17W,		R/W PIPELINE	A-4339	4/9/1970	PERPETUAL,
29								X											R/W COMMUNICATION SITE	A-5308	11/9/1971	EFF 9/28/1971, TO TERM 9/27/2021, TERM AND CASE CLOSED 7/3/1997.	
28										X	X												
29								X	X	X	X	X	X	X	X	X			R/W ELECTRIC TRANSMISSION LINE AND RELATED FACILITIES	A-6692	3/1/1972	TO TERM 2/28/2002, AMENDED 11/26/1974, CASE CLOSED 11/15/2006,	
29																		PART SW,	R/W MICROWAVE TRANSMITTING SITE AND TV RECEIVING SITE	A-6487	3/20/1973	TO TERM 3/19/2023, AMENDED 10/2/1980,	
29													X	X	X	X			R/W COMMUNICATION SITE	A-8037	6/14/1974	TO TERM 12/31/2028, AMENDED 4/2/1975, AMENDED 2/16/1982, AMENDED 4/27/1982,	
29													X	X	X	X			R/W COMMUNICATION SITE	A-8483	9/19/1974	TERM AND CASE CLOSED 4/7/1988,	
29																		PART SW,	R/W COMMUNICATION SITE	A-6487-A	3/15/1976	CASE CLOSED 7/27/1988,	
29																		SWNESW,	R/W COMMUNICATION SITE	A-9141	3/22/1976	TO TERM 3/21/1991, CASE CLOSED 3/22/1991, REF AZA 25151, 3/22/1991,	
29								X											R/W COMMUNICATION SITE	A-7556	8/25/1977	TO TERM 8/24/2007, AMENDED 8/8/1983, AMENDED 4/8/1991, CASE CLOSED 9/13/2011,	
29									X	X									R/W RADIO REPEATER STATION	AR-014225	9/6/1979	TO TERM 9/5/1994, CASE CLOSED 8/21/2001,	
18								X	X	X	X	X	X	X	X	X							
19																		ALL,					
20																		ALL,					
27								X	X	X	X	X	X	X	X	X							
28																		ALL,					
29	X	X	X	X																			
33	X	X	X	X																			

TOWNSHIP 03 NORTH RANGE 20 WEST OF THE GILA & SALT RIVER MERIDIAN, ARIZONA

SECS	SUBDIVISION																Acres	Kind of Entry or Purpose	Serial Number or Order Number	Action Date	Remarks		
	NE 1/4				NW 1/4				SW 1/4				SE 1/4									Lots	Other Description
	NE	NW	SW	SE	NE	NW	SW	SE	NE	NW	SW	SE	NE	NW	SW	SE							
	For orders affecting disposal or use of unidentified lands withdrawn for classification, minerals, water, and/or other public purposes, and Indian treaties, refer to Index to Miscellaneous Documents																						
34																		ALL,					
35																		ALL,					
36																		ALL,		R/W TRANSMISSION LINE	A-9878	2/1/1980	TO TERM 1/31/2030, AMENDED 7/22/1981, AMENDED 6/5/1984, LD TP 1S 6W,
29										X	X	X	X					0.01	R/W COMMUNICATION SITE	A-6487-A	2/13/1980	CANC AND CASE CLOSED 7/27/1988,	
23		X	X											X	X								
26		X	X						X	X	X	X	X										
27											X	X				X	X						
28									X	X	X	X	X	X	X	X	X						
29									X			X			X	X							
34																		N2N2NE,	0.875	R/W MICROWAVE TRANSMITTING SITE AND TV RECEIVING SITE AMENDED	A-6487	10/2/1980	TO TERM 3/19/2023,
1			X	X			X	X	X	X	X	X	X	X	X	X	1-4						
2			X	X			X	X	X	X	X	X	X	X	X	X	1-4						
3			X	X			X	X	X	X	X	X	X	X	X	X	1-4						
4																		ALL,					
9																		ALL,					
10																		ALL,					
11																		ALL,					
12																		ALL,					
13																		ALL,					
14	X	X	X	X	X		X	X	X	X	X	X	X	X	X	X		E2NWNW, SWNWNW,					
23																		ALL,					
24																		ALL,					
25																		ALL,					
26																		ALL,					
35																		ALL,					
36																		ALL,	9821.00	LEASE / OG	A-17462	3/26/1982	EFF 4/1/1982, TERM 4/1/1983, OG SIM JUL 1983,
29									X									0.001	R/W COMMUNICATION SITE	A-7556-A	6/20/1985	TERM AND CASE CLOSED 4/6/1988,	
29									X									55.001	R/W COMMUNICATION SITE	A-6692-A	10/23/1985	TO TERM 10/22/2005, TERM 8/15/1996, CASE CLOSED 8/16/1996,	

TOWNSHIP 03 NORTH RANGE 20 WEST OF THE GILA & SALT RIVER MERIDIAN, ARIZONA

SECs	SUBDIVISION																Acres	Kind of Entry or Purpose	Serial Number or Order Number	Action Date	Remarks		
	NE 1/4				NW 1/4				SW 1/4				SE 1/4									Lots	Other Description
	NE	NW	SW	SE	NE	NW	SW	SE	NE	NW	SW	SE	NE	NW	SW	SE							
	For orders affecting disposal or use of unidentified lands withdrawn for classification, minerals, water, and/or other public purposes, and Indian treaties, refer to Index to Miscellaneous Documents																						
20	X	X	X	X	X	X	X	X									0.04	R/W COMMUNICATION SITE	A-23272	10/5/1988	TO TERM 10/4/2003, CASE CLOSED 5/19/2009,		
18																	4						
19	X	X	X	X	X	X	X	X					X	X									
20									X	X	X	X											
28					X	X	X	X	X	X	X	X	X	X	X	X							
29	X	X	X	X	X	X	X	X															
33	X																						
34	X	X	X	X	X	X	X	X															
35	X	X	X	X	X	X	X	X					X	X	X	X							
36									X	X	X	X	X	X	X	X	1S 6W,	R/W TRANSMISSION LINE	A-23805	8/11/1989	PERPETUAL,		
29									X	X	X	X						R/W COMMUNICATION SITE	AZA-25151	3/22/1991	TO TERM 3/21/2006, CASE CLOSED 9/28/2008, REF AZA 34515, 8/29/2008,		
12																	5.69	PART E2, R/W ROAD	AZA-24957	11/26/1991	TO TERM 11/25/2011, AMENDED 11/26/1991, AMENDED 1/17/1992, RENEWED 12/15/2011, TO TERM 12/31/2030,		
29																	0.026	PART SW, R/W COMMUNICATION SITE	AZA-28841	6/14/1995	TO TERM 6/13/2025,		
1													X	X	X		1	E2E2NE,					
12																		NWNWNE, E2E2NW,	R/W ROAD	AZA-29503	10/28/1996	TO TERM 10/27/2026, OTHER TP 4N 20W,	
23		X	X											X	X								
26		X	X						X	X	X	X	X										
27											X	X			X	X							
28									X	X	X	X	X	X	X	X							
29									X			X			X	X							
34																		N2N2NE,	R/W COMMUNICATION SITE AND ACCESS ROAD	AZA-30302	9/2/1998	TO TERM 9/1/2018,	
23																							
26																							
27																							
28																							
29																							
34																	16.138	N2N2NE, R/W COMMUNICATION SITE	AZA-31014	5/1/2001	TO TERM 12/31/2021,		
27																		WITHIN SWSW,					

TOWNSHIP 03 NORTH RANGE 20 WEST OF THE GILA & SALT RIVER MERIDIAN, ARIZONA

SECS	SUBDIVISION																Acres	Kind of Entry or Purpose	Serial Number or Order Number	Action Date	Remarks				
	NE 1/4				NW 1/4				SW 1/4				SE 1/4									Lots	Other Description		
	NE	NW	SW	SE	NE	NW	SW	SE	NE	NW	SW	SE	NE	NW	SW	SE									
For orders affecting disposal or use of unidentified lands withdrawn for classification, minerals, water, and/or other public purposes, and Indian treaties, refer to Index to Miscellaneous Documents																									
28																			WITHIN NESW, SWSW, NWSESW, S2NWSE, NESWSE, SESE,						
29																			WITHIN S2NESW, N2SESW, S2SE,						
34																			WITHIN N2NE, NESENE, N2NW,						
35																			WITHIN S2NE, S2NW,						
36																			WITHIN S2SWNW, N2NESW, NENWSW, N2SE,		R/W OVERHEAD ELECTRIC DISTRIBUTION LINE AND ACCESS ROADS AMENDED	AR-032619	7/27/2001	TO TERM 10/28/2014, LD TP 2N 19W,	
28										X	X														
29								X	X	X	X			X	X					21 13	R/W COMMUNICATION SITE	AZA-32361	2/19/2004	EFF 3/1/2002, TO TERM 2/28/2022,	
6					X	X			X	X									1-4						
7					X	X			X	X									1-4						
18					X	X													1-5	LD TP 4N 20W,		PL WDL COLORADO RIVER INDIAN RESERVATION	109-47	8/2/2005	LANDS HELD IN TRUST BY THE US ON BEHALF OF THE COLORADO RIVER INDIAN TRIBES, WITHDRAWN FROM THE PUBLIC LAND LAWS AND THE MINING LAWS, INCLUDING THE MINERAL LEASING LAWS,
29								X	X	X	X									15 97	R/W COMMUNICATION SITE	AZA-34515	8/29/2008	TO TERM 12/31/2027,	
23		X	X										X	X											
26		X	X					X	X	X	X	X													
27										X	X			X	X										
29								X			X														
34																			N2N2NE,	1 00	R/W COMMUNICATION SITE	AZA-35195	10/28/2009	TO TERM 12/31/2028,	
10													X												
11								X	X			X	X												
12									X											1 00	R/W ROAD	AZA-35714	9/23/2011	TO TERM 12/31/2030,	
23		X	X										X	X											
26		X	X					X	X	X	X	X													
27										X	X			X	X										
28								X	X	X	X	X	X	X	X	X									
29								X			X														
34																			N2N2NE,	15 91	R/W COMMUNICATION SITE	AZA-35985	9/25/2012	TO TERM 12/31/2031,	

TOWNSHIP 03 NORTH RANGE 20 WEST OF THE GILA & SALT RIVER MERIDIAN, ARIZONA

SECS	SUBDIVISION																Acres	Kind of Entry or Purpose	Serial Number or Order Number	Action Date	Remarks		
	NE 1/4				NW 1/4				SW 1/4				SE 1/4									Lots	Other Description
	NE	NW	SW	SE	NE	NW	SW	SE	NE	NW	SW	SE	NE	NW	SW	SE							
For orders affecting disposal or use of unidentified lands withdrawn for classification, minerals, water, and/or other public purposes, and Indian treaties, refer to Index to Miscellaneous Documents																							
11																		PART SESE;					
12																		PART SESWNW, SENW, W2SW;					
13																		PART SWSW;					
14																		PART NE, SENW, E2SW, S2SE;					
23																		PART N2NE;					
24																		PART N2NE, N2NW;	R/W ROAD	AZA-35714-01	9/27/2012	TO TERM 12/31/2031;	

196 Rainbow Dr #9698
LIVINGSTON, TX 77399

PHOENIX AZ 852

27 DEC 2016 PM 9:1



RECEIVED
BLM AZ STATE OFFICE

2016 DEC 29 P 2:43

PHOENIX, ARIZONA

B.L.M

ONE North CENTRAL AVE
SUITE 800

Phoenix, AZ

85004-442700

85004

